



RIDGECREST

CONFERENCE CENTER

Dogwood

| ROOMS | ROOM SIZE | CLASSROOM | ROUNDS | THEATER |
|--------------|-----------|-----------|--------|---------|
| 1 A-C | 32'x92' | 88 | 152 | 200 |
| 1 A | 32'x23' | 20 | 48 | 50 |
| 1 B | 32'x25' | 24 | 48 | 60 |
| 1 C | 32'x44' | 48 | 96 | 90 |
| 2 A-D | 28'x118' | | 200 | |
| 2 A-D (each) | 28'x29' | 24 | 32 | 50 |

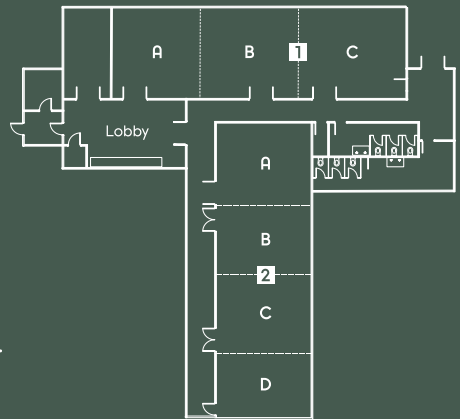

Numbers shown are maximum occupancy per space.



CLASSROOM



ROUNDS



THEATER

*Images are for demonstrating set-up style only.